

ISO 8750 Medium-Standard Duty Coiled Pins

Medium Standard
Duty

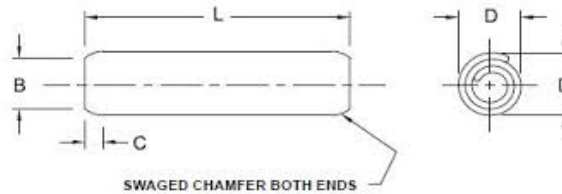

ISO 8750 Medium-Standard Duty Coiled Pins																
Nominal Diameter		0.8	1	1.2	1.5	2	2.5	3	4	5	6	8	10	12	16	20
Expanded Diameter	Max.	0.91	1.15	1.35	1.73	2.25	2.78	3.30	4.40	5.50	6.50	8.63	10.80	12.85	17.00	21.10
	Min.	0.85	1.05	1.25	1.62	2.13	2.65	3.15	4.20	5.25	6.25	8.30	10.35	12.40	16.45	20.40
Chamfer																
B Diameter	Max.	0.75	0.95	1.15	1.40	1.90	2.40	2.90	3.90	4.85	5.85	7.80	9.75	11.70	15.60	19.60
	C Length Ref.	0.30	0.30	0.40	0.50	0.70	0.70	0.90	1.10	1.30	1.50	2.00	2.50	3.00	4.00	4.50
Recommended																
Hole Diameter	Max.	0.84	1.04	1.24	1.60	2.10	2.60	3.10	4.12	5.12	6.15	8.15	10.15	12.18	16.18	20.21
	Min.	0.80	1.00	1.20	1.50	2.00	2.50	3.00	4.00	5.00	6.00	8.00	10.00	12.00	16.00	20.00

L - Available Lengths From 5m/m - 100 m/m Depending On Diameter

Available In Stainless Steel - 0.8m/m - 1.2m/m Diameter

Available In High Carbon Steel & Stainless Steel - 1.5m/m - 12m/m Diameter

Available In Alloy Steel Only - 16m/m & 20m/m Diameter

Finishes Plain Oiled & Electroplated Zinc

INFORMATION AND DRAWINGS PROVIDED ARE FOR REFERENCE ONLY